

# Model SG-PT4000

## Universal S-Type

Capacities: 0-20kg to 0-5t  
and 0-50lbs to 0-20,000lbs

Tool Steel Construction

Electroless nickel plated

Tension and compression universal loading

Can be used for multi-point weighing or scale conversion

Temperature compensation, both zero and span

Environmental protection to IP67



... better loadcells by design



### Specifications

Nominal Capacity	20kg to 5t 50lbs to 20,000lbs
Nominal Output at capacity	3mV/V $\pm$ 0.1%
Linearity error	<0.017% FSO
Repeatability	<0.01% FSO
Creep/Zero return (30 minutes)	<0.023%/0.017% FSO
Temp effect on span/10°C	<0.010% FSO
Temp effect on zero/10°C	<0.0015% Capacity
Insulation resistance	>5000M $\Omega$ at 100VDC
Compensated temperature range	-10° to 40°C 14° to 104°F
Input resistance	415 $\Omega$ $\pm$ 15 $\Omega$
Output resistance	352 $\Omega$ $\pm$ 3 $\Omega$
Service load	100% of capacity
Safe load	150% of capacity
Mechanical failure	>300% of capacity
Recommended excitation	5V to 15V AC/DC
Maximum Excitation	18VDC
Environmental protection	IP67

Capacity (Metric)	Order Code	Capacity (Imperial)	Order Code
20kg	SG-PT4000-20	50lb	SG-PT4000-50LB
50kg	SG-PT4000-50	100lb	SG-PT4000-100LB
100kg	SG-PT4000-100	150lb	SG-PT4000-150LB
200kg	SG-PT4000-200	200lb	SG-PT4000-200LB
500kg	SG-PT4000-500	250lb	SG-PT4000-250LB
1t	SG-PT4000-1T	300lb	SG-PT4000-300LB
2t	SG-PT4000-2T	500lb	SG-PT4000-500LB
3t	SG-PT4000-3T	750lb	SG-PT4000-750LB
5t	SG-PT4000-5T	1000lb	SG-PT4000-1KLB
		1500lb	SG-PT4000-1K5LB
		2000lb	SG-PT4000-2KLB
		2500lb	SG-PT4000-2K5LB
		3000lb	SG-PT4000-3KLB
		5000lb	SG-PT4000-5KLB
		10000lb	SG-PT4000-10KLB
		20000lb	SG-PT4000-20KLB

Cabling:  
 Red +ve Excitation  
 Black -ve Excitation  
 Green +ve Signal  
 White -ve Signal  
 Cable length 6 metres

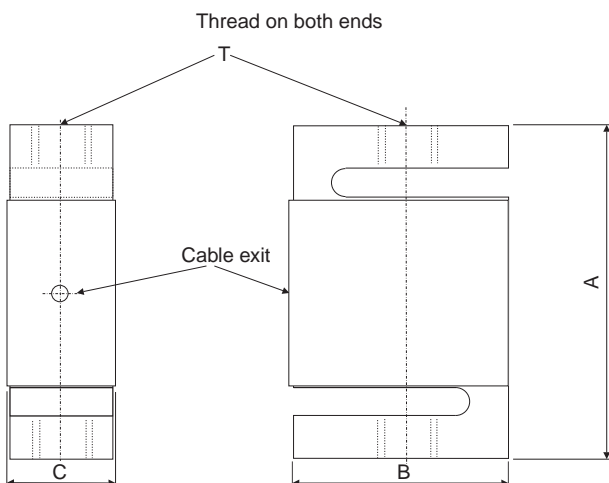

Capacity	A	B	C	T
50lb to 300lb	2.5"	2.0"	0.62"	¼" UNF
500lb to 1500lb	2.5"	2.0"	0.87"	½" UNF
2000lb to 2500lb	2.5"	2.0"	1.1"	½" UNF
3000lb	3.0"	2.0"	1.1"	½" UNF
5000lb to 10000lb	4.0"	3.0"	1.3"	¾" UNF
20000lb	5.9"	4.5"	2.0"	1¼" UNF
20kg to 100kg	63.5mm	51mm	16mm	M8x1.25P
200 kg to 500kg	63.5mm	51mm	22mm	M12x1.75P
1t	63.5mm	51mm	28mm	M12x1.75P
2t	101.6mm	76mm	33mm	M20x1.5P
3t to 5t	101.6mm	76mm	33mm	M24x2P

LOP\_4000-3.1-1

## AMALGAMATED INSTRUMENT CO PTY LTD

ACN: 001 589 439

Unit 5, 28 Leighton Place Hornsby  
NSW 2077 AUSTRALIA

Telephone: +61 2 9476 2244  
Facsimile: +61 2 9476 2902

e-mail: sales@aicpl.com.au  
Internet: www.aicpl.com.au

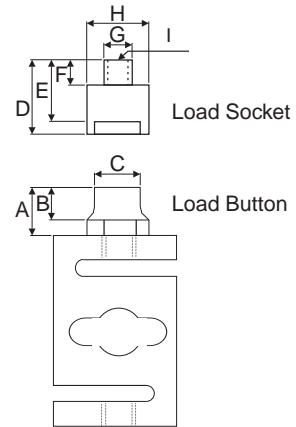
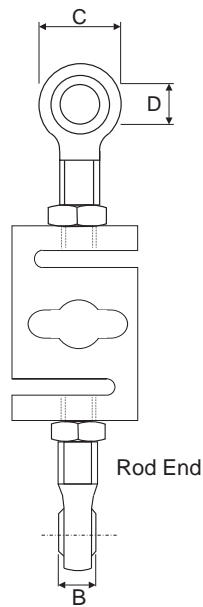

Rod ends are used with the SG-PT4000 load cell for tension applications. They are used singularly or in pairs and provide ease of installation with self aligning action.

Rod end bearing Dimensions	20kg - 100kg	200kg - 1T	2T	3T - 5T
<b>B</b>	12mm	16mm	25mm	31mm
<b>C</b>	22.25mm	30mm	46mm	60mm
<b>D</b>	8mm	12mm	20mm	25mm
<b>Centre of hole to end of thread</b>	42mm	54mm	78mm	94mm
<b>Thread</b>	M8 x 1.25	M12 - 1.75	M20 - 1.5	M24 x 2

load button dimensions	20kg to 100kg	200kg, 500kg, 1T	2T	3T, 5T
<b>A</b>	12	12	18	18
<b>B</b>	7	5	10	10
<b>C</b>	14	14	20	20
<b>Thread</b>	M8 x 1.25	M12 x 1.75	M20 x 1.5	M24 x 2.0
load socket dimensions	20kg to 100kg	200kg, 500kg, 1T	2T	3T,5T
<b>D</b>	20mm		28mm	
<b>E</b>	17mm		24mm	
<b>F</b>	7mm		8mm	
<b>G</b>	10mm		16mm	
<b>H</b>	20mm		30mm	
<b>I</b>	M6 x 1P 10 deep		M10 x 1.5P 10 deep	

A load button and hardened socket are used with the AST in compression applications. With the load cell rigidly fixed at the base, load is applied through the socket. If a load button is attached top and bottom, the load cell converts to self centering pendle action

SG-PT4000	20kg - 100kg	200kg - 1T	2T	3T - 5T
<b>Rod end bearing</b>	SG-A-REM8N	SG-A-REM12N	SG-A-REM20N	SG-A-REM24N
<b>Load button</b>	SG-A-LBM8	SG-A-LBM12	SG-A-LBM20	SG-A-LBM24
<b>Load Socket</b>	SG-A-LS20		SG-A-LS30	